



## What do you need to start?

- 1 - Piece of paper or Graph paper for better results.
- 2 - Measuring tape/ laser measuring tool. Set Units to metric.
- 3 - A nice sharp pencil or retractable pencil and a rubber.



## Few symbols to assist you on the drawing

For making this task easier, we've create a Graph with all symbols you going to need. Simple and easy, to help you drawing your Floor Plan Sketch. Keep in mind the symbols are only to illustrate, so you wont have to reproduce it exatcly like the Graph.

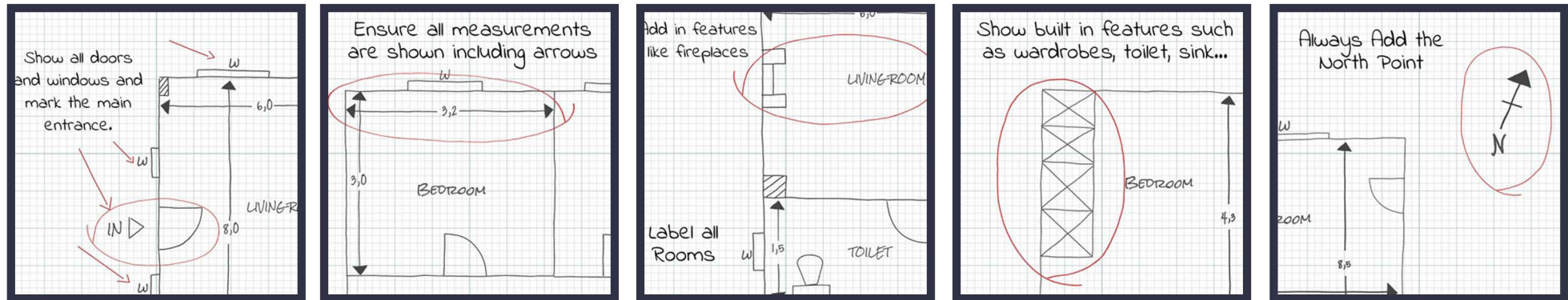
## 1. Starting your sketch

- Start using a corner of you graph paper (or any other).
- Try to keep spaces in proportion relative to each other and use the scale provided.

## 2. Measuring Rooms

- Start measuring the widest parts of the room to gain its main dimensions.
- Add the room dimension in a clear way to avoid being cluttered with the other line work.
- Name the rooms clearly and put all dimensions on your sketch.
- Don't forget to represent all the doors and windows cleary adding the right amount of each one in every room.
- Indicate all the kitchen and bathroom areas in a clear way. Use the symbols for reference.

## 3. Final Checks

- Please check all the details, making sure all the rooms and dimensions are correct
- If you're not 100% sure, don't worry, send us anyway and we'll get back to you if we have any questions.

## 4. Sending your Project/Image

- Once your finish your sketch, make a good quality scan or photo. Make sure that the scan or photo is clear and easy to ready.